

thesocial

FOH Systems and Specs

- * Analog 24 channel Main Snake no split
- * Analog 32 channel Soundcraft GB8
- * Ashley GQX3102-House EQ
- * Powersoft amps on all EAW cabinets
- * 3-EAW KF730/per side
- * 2-EAW SB528z/subs
- * Note - Aux outputs are 1/4in.

FX

- * Yamaha SPX2000
- * Lexicon MX300
- * TC Electronic D2 w/tap pedal

DYNAMICS

- * 1-DBX 1074-Gate
- * 2-DBX 166 XL-Comp/Gate
- * 1-DBX 1046 Comp

MONITORS

- * 4-JBL loaded, Bi-Amp Monitor Mixes
powered by Crown MacroTech2406
- * 3- Klark Teknik DN370 dual 31 band EQ
- * 2-Passive Yamaha Monitor Mixes,
powered by QSC PLX3102
- * Note - We do not have a separate monitor
console. Monitors are run from FOH - 6 Mixes Max

STAGE DIMENSIONS

- * 10ft Deep at Center
- * 8ft Deep at Stage L/Stage R
- * 28ft Wide

MICROPHONES & Dis:

- * 6-Shure SM58
- * 6-Shure SM57
- * 4-Shure Beta56
- * 1-Shure SM91
- * 2-Shure Beta52
- * 3-Sennheiser e835
- * 2-Sennheiser e609
- * 2-Sennheiser wireless G3 EW100
- * 5-Passive Direct Boxes
- * 2-Stereo Passive Direct Boxes
- * 7-Tall Boom Mic stands w/tripod base
- * 9-Short Boom Mic stands
- * 2-Straight Mic stands w/round base
- * 9-10ft XLR cables
- * 10-15ft XLR cables
- * 4-25ft XLR cables
- * 6-5ft XLR cables

LIGHTING

- * On Stage: 24-Par56 w/300 watt
MFL-paired on 15 Dimmer channels-
16 Channel Lighting Board
- * 8 -Par56 Front wash
- * Disco Ball!-on Dimmer

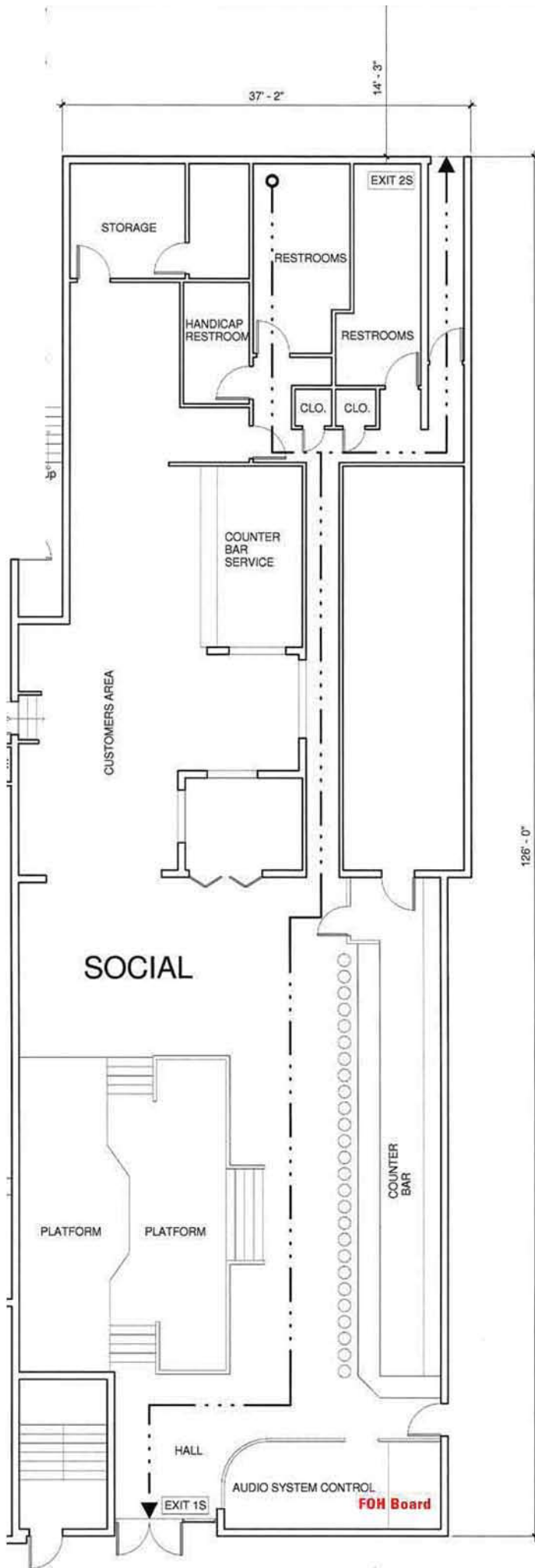

thesocial

54 N Orange Ave. Downtown, Orlando
 407.246.1419 THESOCIAL.ORG



thesocial

54 N Orange Ave. Downtown, Orlando
407.246.1419 THESOCIAL.ORG